

Dimensional Documentation

viega

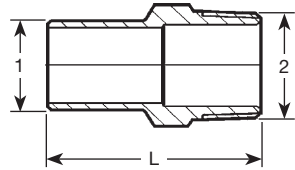

Bronze Adapter FTG x MPT - Model 2911.1ZL

Part Number	Size		L (in)
	1	2	
79375	1/2"	3/8" MPT	1.75
79380	1/2"	1/2" MPT	1.95
79385	1/2"	3/4" MPT	2.05
79390	3/4"	1/2" MPT	1.93
79395	3/4"	3/4" MPT	2.05
79400	1"	3/4" MPT	2.05
79405	1"	1" MPT	2.22
79410	1 1/4"	1 1/4" MPT	2.54
79415	1 1/2"	1 1/2" MPT	2.89
79420	2"	2" MPT	3.33

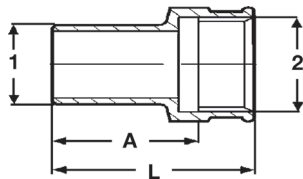

Bronze Adapter FTG x FPT - Model 2912.1ZL

Part Number	Size		A (in)	L (in)
	1	2		
79425	1/2"	3/8" FPT	1.13	1.54
79430	1/2"	1/2" FPT	1.22	1.75
79435	1/2"	3/4" FPT	1.28	1.83
79440	3/4"	1/2" FPT	1.26	1.79
79445	3/4"	3/4" FPT	1.28	1.83
79455	1"	1/2" FPT	1.45	1.99
79450	1"	1" FPT	1.33	1.99
79460	1 1/4"	1/2" FPT	1.65	2.19
79465	1 1/4"	1 1/4" FPT	1.50	2.19
79470	1 1/2"	1 1/2" FPT	1.88	2.56
79475	2"	2" FPT	2.26	2.95

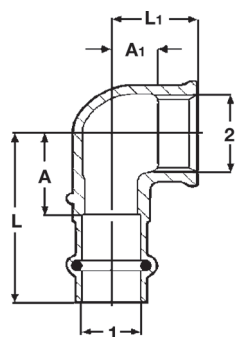

Bronze Elbow 90° P X FPT - Model 2914.2ZL

Part Number	Size		A (in)	A1 (in)	L (in)	L1 (in)
	1	2				
79520	1/2"	3/8" FPT	0.95	0.42	1.77	0.83
79525	1/2"	1/2" FPT	0.95	0.57	1.77	1.10
79530	1/2"	3/4" FPT	1.06	0.51	1.89	1.06
79535	3/4"	1/2" FPT	1.06	0.65	1.97	1.18
79540	3/4"	3/4" FPT	1.06	0.57	1.97	1.12
79545	1"	1/2" FPT	1.06	0.72	1.97	1.26
79550	1"	1" FPT	1.34	0.76	2.24	1.42
79560	1 1/4"	1 1/4" FPT	1.54	0.89	2.56	1.58
79565	1 1/2"	1 1/2" FPT	1.69	1.05	3.11	1.73
79570	2"	2" FPT	2.17	1.35	3.74	2.05